

EXHIBIT B

SW 1/4 SEC. 27
T3S, R68W, 6TH PM

GARDEN ADDITION TO DENVER
BLOCK 10

PARCEL CONTAINS
0.002 ACRES
(101 SQ.FT.),
MORE OR LESS.

POINT OF BEGINNING

MOST WESTERLY
CORNER TRACT F

N89°58'19"E 13.43' (BASIS OF BEARINGS)
NORTHERLY BOUNDARY OF TRACT F N89°58'19"E 150.21'

N41°46'12"W 20.16'

S00°01'41"E 15.05'

VACATED W.32ND AVE

TRACT F
DENARGO MARKET
SUBDIVISION FILING NO. 1
REC. NO. 2009018921
2/17/2009

BLOCK 15

GARDEN ADDITION TO DENVER

10

11

12

13

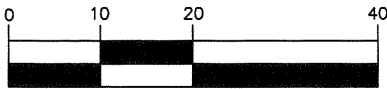

1 inch = 20 ft.

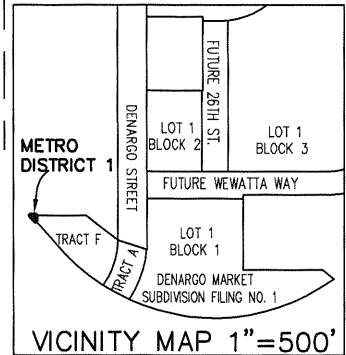

NOTE: THIS DRAWING DOES NOT REPRESENT A FIELD MONUMENTED SURVEY AND IS ONLY INTENDED TO DEPICT THE ATTACHED LEGAL DESCRIPTION.

REVISED 1/05/2010 DCR

PATH: P:\52109-01\DWG
DWG NAME: LEGAL - MD-1.DWG
DWG: JJP CHK: DCR
DATE: 11/06/2009
SCALE: 1" = 20'



AZTEC
CONSULTANTS, INC.

300 East Mineral Ave., Suite 1
Littleton, Colorado 80122
Phone: (303) 713-1898
Fax: (303) 713-1897
www.aztecconsultants.com

MAP OF DISTRICT 1 BOUNDARIES

PART OF THE SW 1/4 SEC 27, T3S, R68W, 6TH PM
CITY & COUNTY OF DENVER, COLORADO

JOB NUMBER 52109-01

2 OF 2 SHEETS